

naughtone

Supporting the ways
people work, together



Useful Beautiful Furniture
British Designed
Since 2005

Collaborative solutions for the future-proof workspace

What's been missing over the last year of working from home is genuine connection, and collaboration. To stay relevant and support those who work there, workplaces therefore require hard-wearing furniture that encourages interaction. It's here that naughtone's soft seating delivers. Welcoming forms designed with ergonomics and comfort in mind create a positive seated experience, while inviting people to come together.





- 1 Collaborative solutions for the futureproof workspace
- 3 How people work
- 4 Create connection in your workspace
- 7 Get in touch

How people work

Whether we work together or alone,
we tend to adopt one of 10 workplace behaviours.

TOGETHER:

Chat

incidental and impromptu interactions

Converse

interactions for the purpose of addressing a specific topic

Huddle

when a team comes together to address urgent issues or discuss a plan of action

Co-Create

generating new ideas and content as a group

Divide & Conquer

when a group spreads out to work on their own aspects of a larger project

Show & Tell

planned team information sessions, with or without clients

Warm Up, Cool Down

pre-meeting gatherings or post-meeting wind downs

ALONE:

Process & Respond

processing the day and responding to emails

Create

generating new ideas and content on an individual level

Contemplate

solo time spent relaxing and reflecting on ideas



Chat



Converse



Huddle



Co-Create

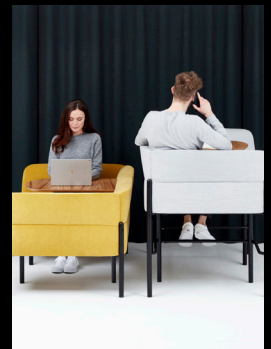

Divide & Conquer



Show & Tell



**Warm Up,
Cool Down**



**Process &
Respond**



Create

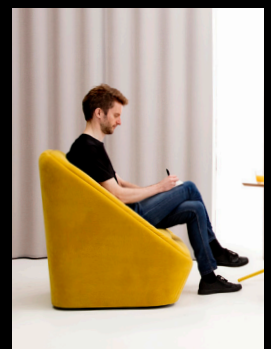

Contemplate

Create connection in your workspace

The right furniture will help you power interaction in the office. This is where naughtone excels, bringing a pared-down lifestyle aesthetic to commercial furniture. Robust, well-crafted and original designs combine with distinctive upholstery options to create a look that feels reassuringly like home.

Founded in the UK in 2005, naughtone has been a member of the Herman Miller family since 2019. Now available in Australia and New Zealand, the British brand is set to transform soft seating in the modern workspace.



Plaza

The dynamic heart of any organisation, the Plaza acts as a vibrant connection point where people can come together. It's the first place anyone entering the workspace will encounter. It offers a variety of settings and postural choices to suit all kinds of work – together or alone.



Supports: Chat / Converse / Huddle / Contemplate

1. Chat: Easy to get in and out of, the Always Lounge Chair supports the casual seated space. The lightweight Lasso stool creates impromptu clusters, while the Trace Coffee Table can be customised to fit your brand.

2. Converse: Symbol, a modular sofa that can be configured to suit your needs. Support your set-up with the enveloping Cloud Armchair, and the Ali Table, available in a range of heights and sizes.

3. Huddle: Bar-height furniture like the Fold Construct Stool promotes engaged, solutions-oriented interactions, enabling people to move from sit to stand with ease.

4. Contemplate : Get focused with Hatch, which offers a comfortable, upright sit and the option to integrate power access. Pop your jacket on the Hudson Coat Rack, put your device on the laptop-height Knot Table and you're good to go.

Cove

The Cove setting facilitates movement between individual workstations and connection areas. People can get on with focus work, regrouping to problem-solve and bounce ideas around.

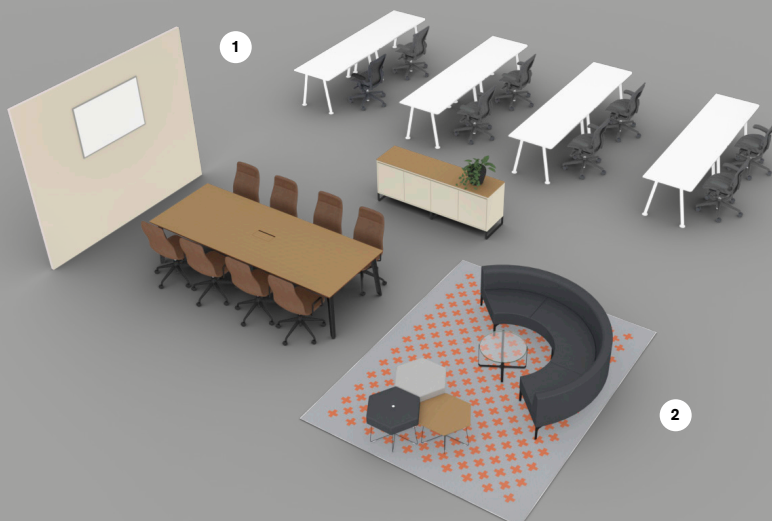

1. Co-Create / Show & Tell / Divide & Conquer: Present or generate ideas at the Fold Table. A robust everyday meeting table, it accommodates power and data for online sessions and solo work. Sit comfortably in the Viv Highback Chair, perfect for longer seated sessions – together or alone.

2. Converse / Divide & Conquer: The modular Symbol Sofa delivers a comfortable, upright sit that's ideal for conversations, information-sharing and solo work alike. Fabrics and finishes can be customised to suit your needs. Support this with the easy-to-move Pollen Stool for larger group gatherings and spontaneous interactions, and the Trace Coffee Table.

Supports: Converse / Co-Create / Show & Tell / Divide & Conquer

Jump Space

Consisting of highly approachable work points, the Jump Space enables people to jump into focus work in-between other activities.



Supports:
Converse / Chat / Contemplate / Divide
& Conquer / Show & Tell

1. Converse / Chat / Contemplate / Divide & Conquer: The Hue Bar Height Booth invites casual collisions and longer conversations. It's a great spot for contemplation over coffee, and for focus work where you need your team on hand for input. Plus it offers a handy way to make use of awkward corridor space.

2. Show & Tell: Introduce information or present to your team at the Dalby Bar Height Table. Support this with the Always Bar Stool, a comfortable, armchair-style stool primed for longer perches.

Landing

Adjacent to Meeting Spaces and Forums, the Landing is where people gather pre- and post-meeting, warming up and cooling down together or solo.

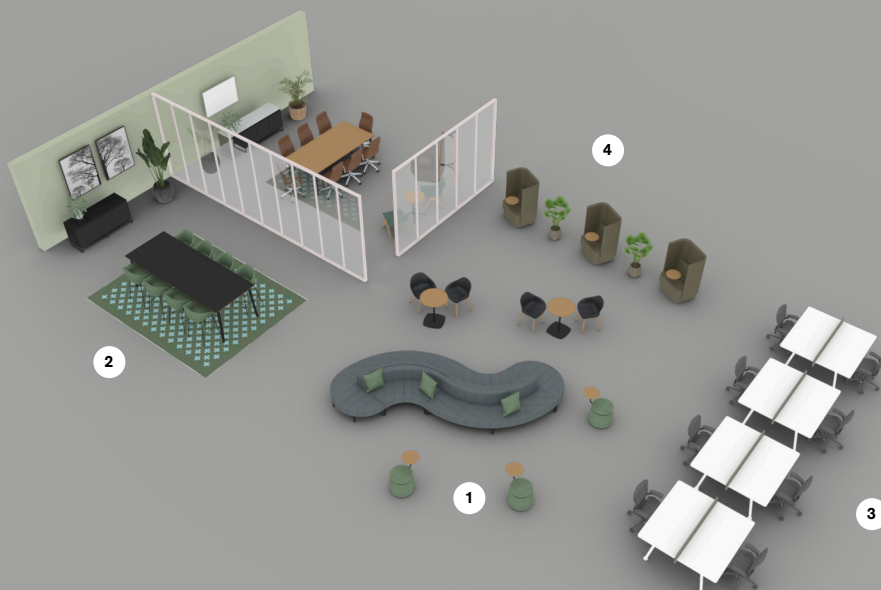

Supports: Chat / Converse / Divide & Conquer / Contemplate

1. Chat: Encourage impromptu conversations by dotting the Lasso Stool around your space. Lightweight and moveable, it's also easy to wipe down. Perch coffee or devices on the optional table attachment.

2. Converse : The Ruby Chair offers a supportive sit for team discussions. Meanwhile the Ped Table provides a practical and robust surface for working on, or for sharing information in a casual format.

3. Divide & Conquer:
The Fold Table comes in a variety of heights, delivering a durable, versatile surface on which to get the job done or showcase your work. The Always Barstool provides a comfortable, upholstered seat for longer interactions or focus time.

4. Contemplate / Process & Respond: Creating privacy is the Pullman Armchair. With its high back, it blocks out distractions, while facilitating work on devices thanks to integrated power and data options. It's the perfect space for solo idea generation or processing admin at the end of the day.

Get in touch

Want more insights on creating future-proof workspaces that foster collaboration and connection? Reach out to your local Market Manager for more ideas.

Find out more

Liam Nicholls

Market Manager VIC/SA/WA/NT/ACT

+61 433 558 432

liam_nicholls@hermanmiller.com

Gigi Davidge

Market Manager

NSW/QLD/NZ

+61 411 653 757

gigi_davidge@hermanmiller.com

naughtone

Useful Beautiful Furniture
British Designed
Since 2005